



Swarthmore **PUBLIC REALM**

concepts



VIBRANCY



AESTHETICS



ACCESSIBILITY



SAFETY





VIBRANCY



AESTHETICS



ACCESSIBILITY



SAFETY

PARK AVE BOARDWALK AND LANDSCAPING



INTERSECTION SEATING AND CURB EXTENSIONS



PUBLIC FLEX SPACE ON PARK AVE



MYERS AVE ENHANCEMENTS



MURALS



ALLEY ACTIVATION AND CONNECTIONS



PARK AVE LIGHTING



LIGHTING ON BUILDINGS



SIGNAGE AND WAYFINDING



Myers Ave Project Extent & Goals



- **Create safer bike / ped connections**, especially between Lincoln & Princeton.
- **Increase greenery, tree canopy, and lighting**, especially between Lincoln & Princeton.
- Create a **sense of place** that visually ties Myers in to Swarthmore Town Center.
- Install **new fencing** along rail line.
- **Preserve/manage parking supply**.

The existing fence is in need of repair/replacement, and stops just east of the Co-Op.



There are no sidewalks or bike lanes between Lincoln and Princeton



Design Proposals

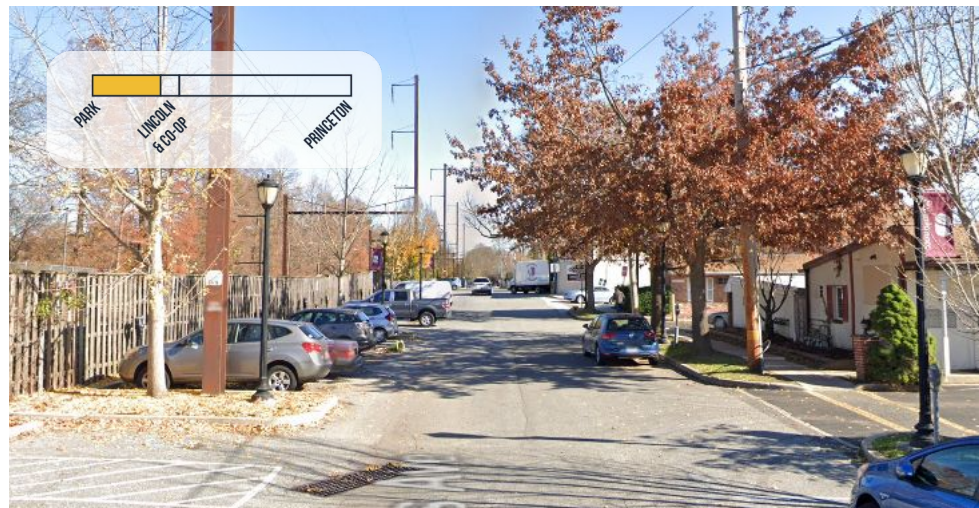

MYERS AVE. - EXISTING

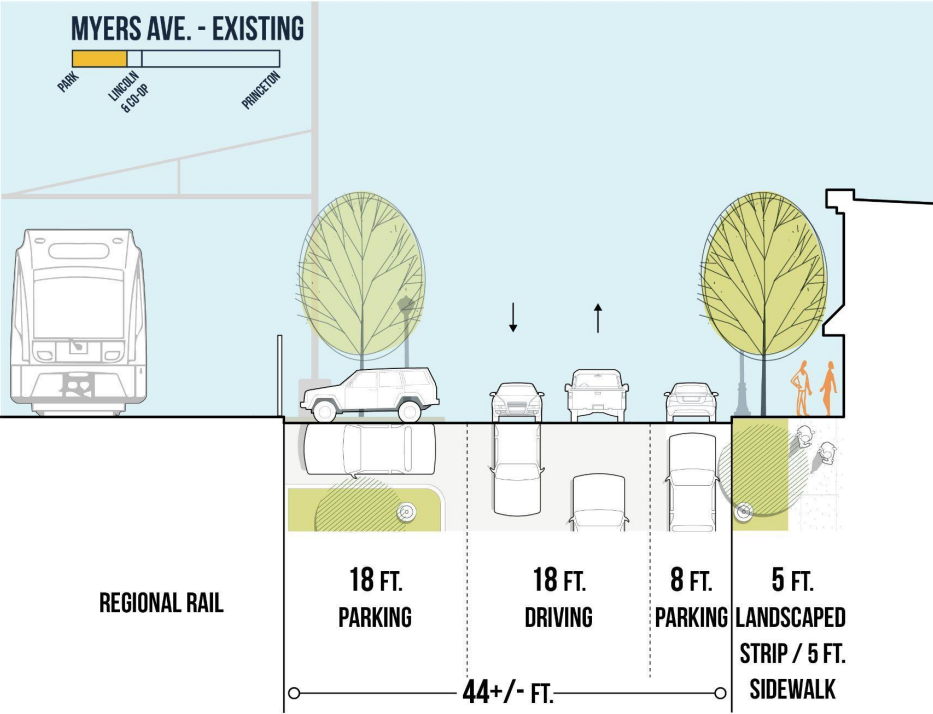

MYERS AVE. - EXISTING

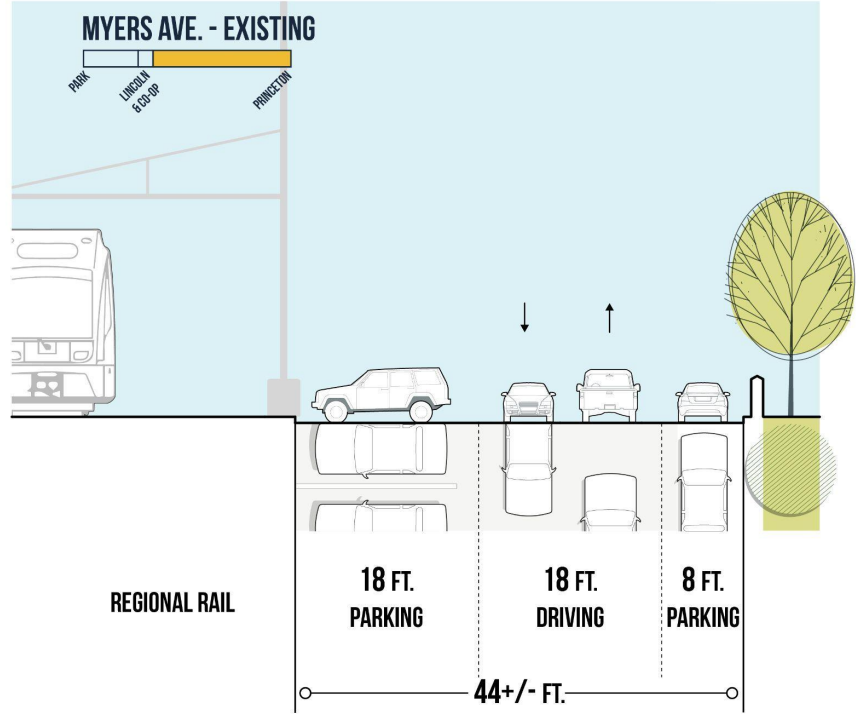

Option 1

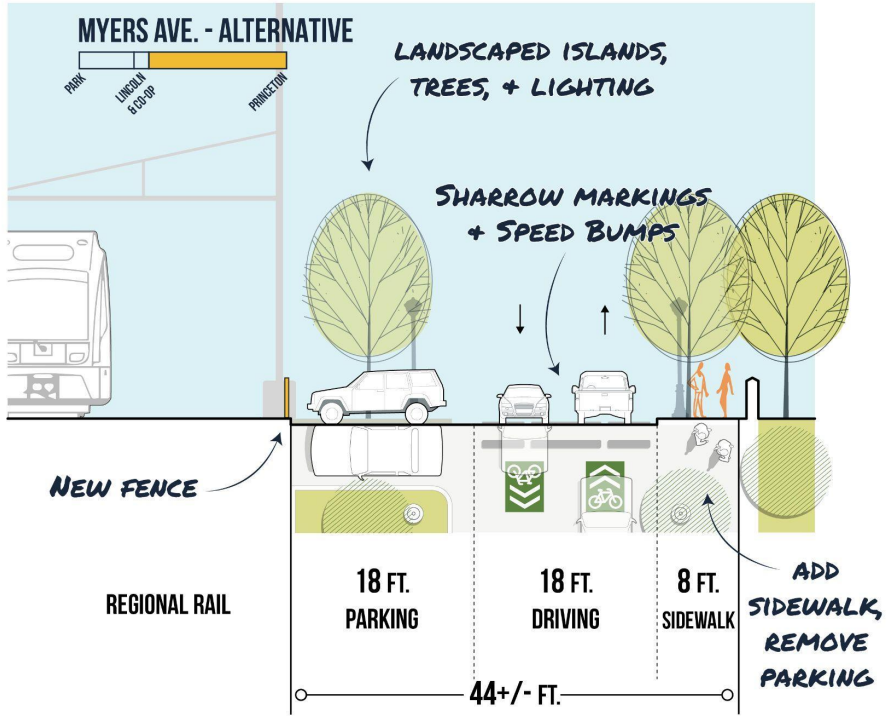
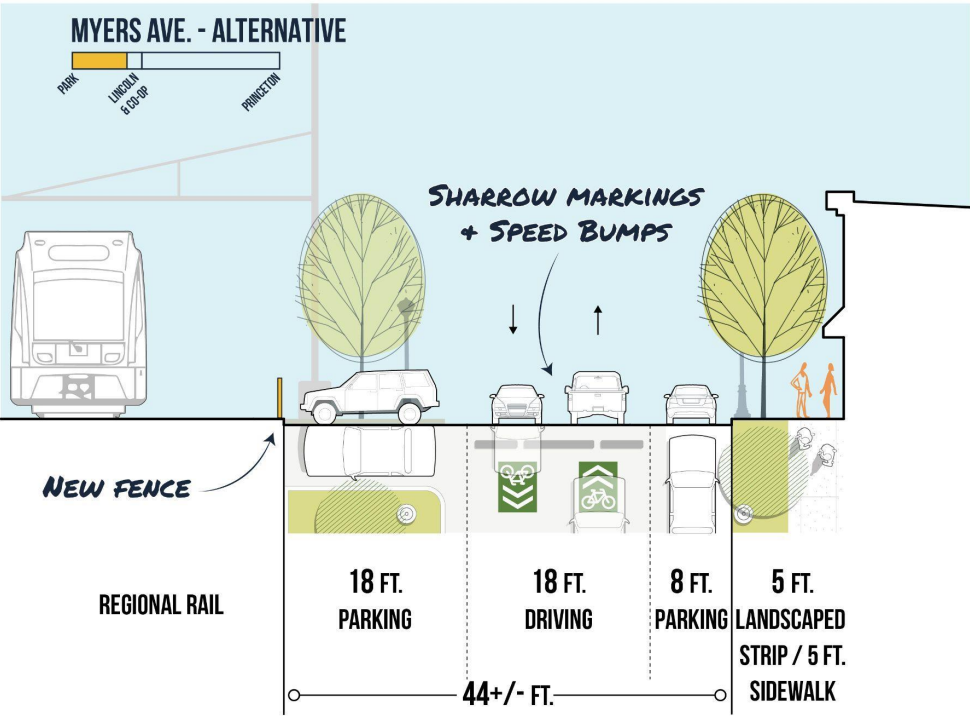

-8 parking spaces

-32 parking spaces



Option 2

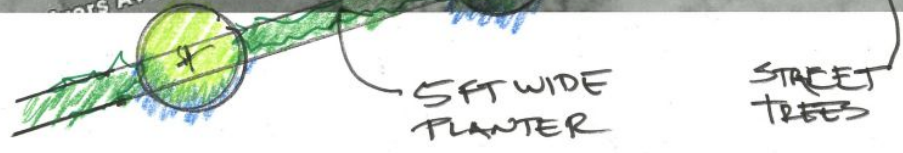

(B) MYERS AVE
23 FEB 21
↑
H

Option 2

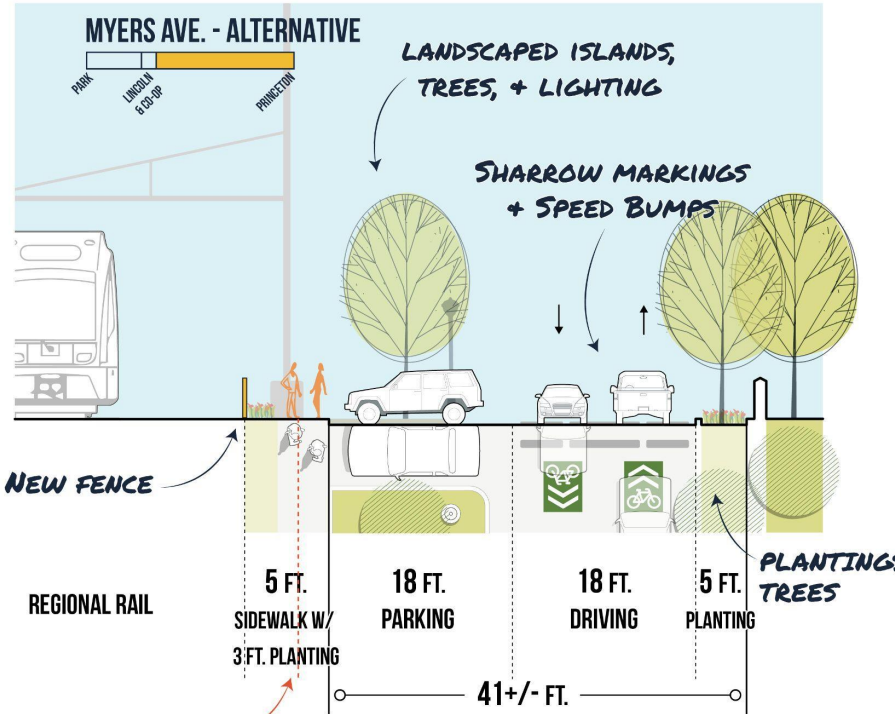
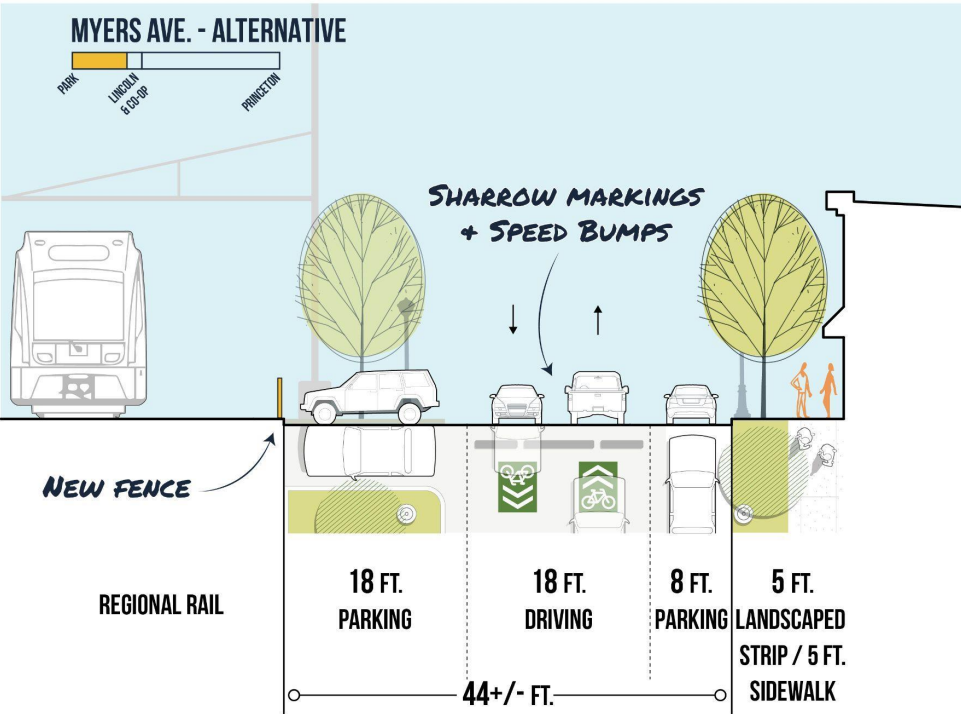

-8 parking spaces

-32 parking spaces

Option 3

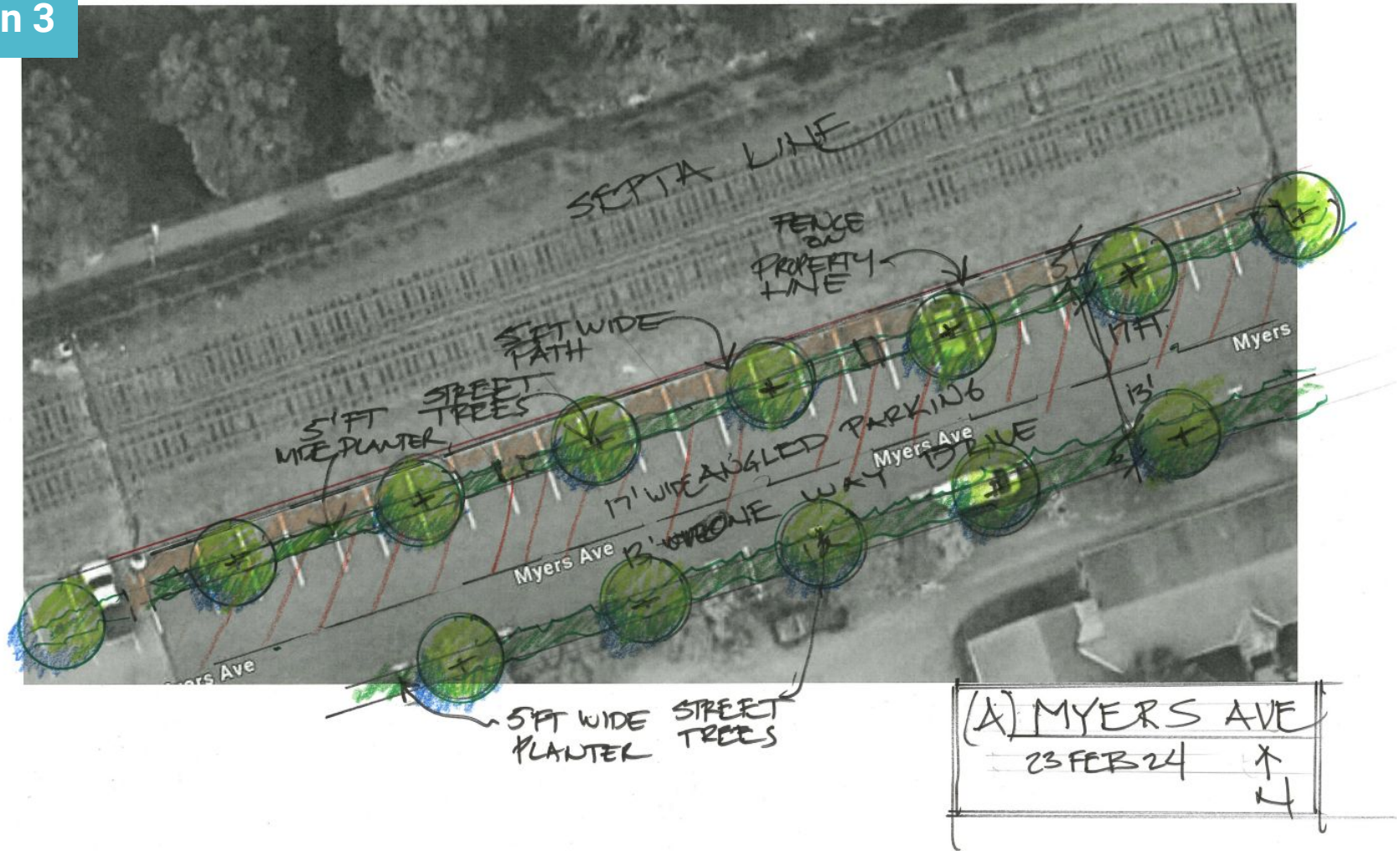

(A) MYERS AVE
23 FEB 24
↑
4

Option 3

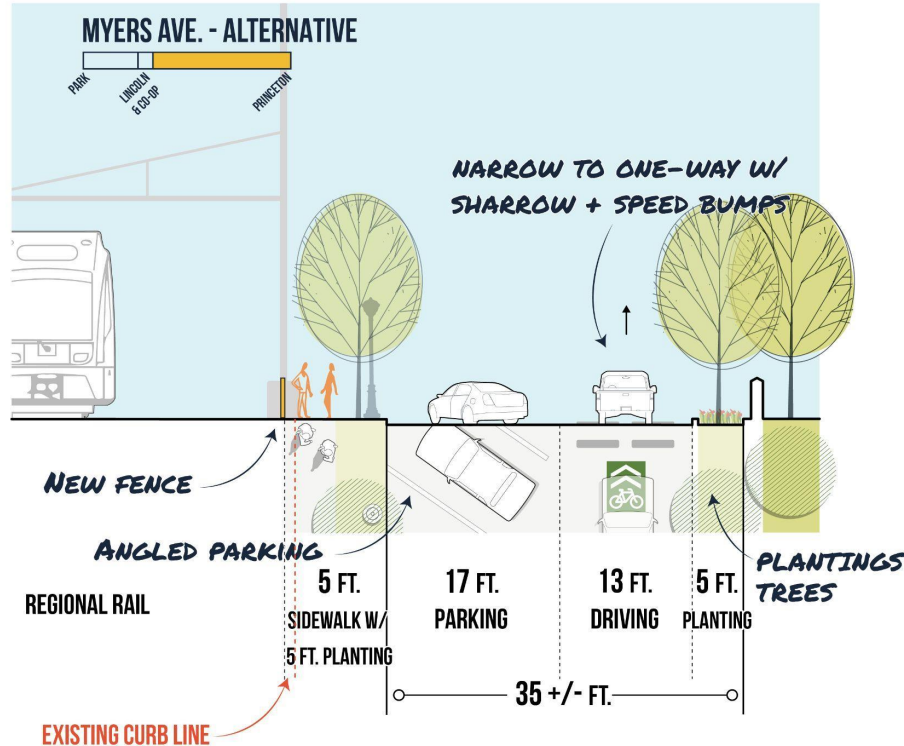
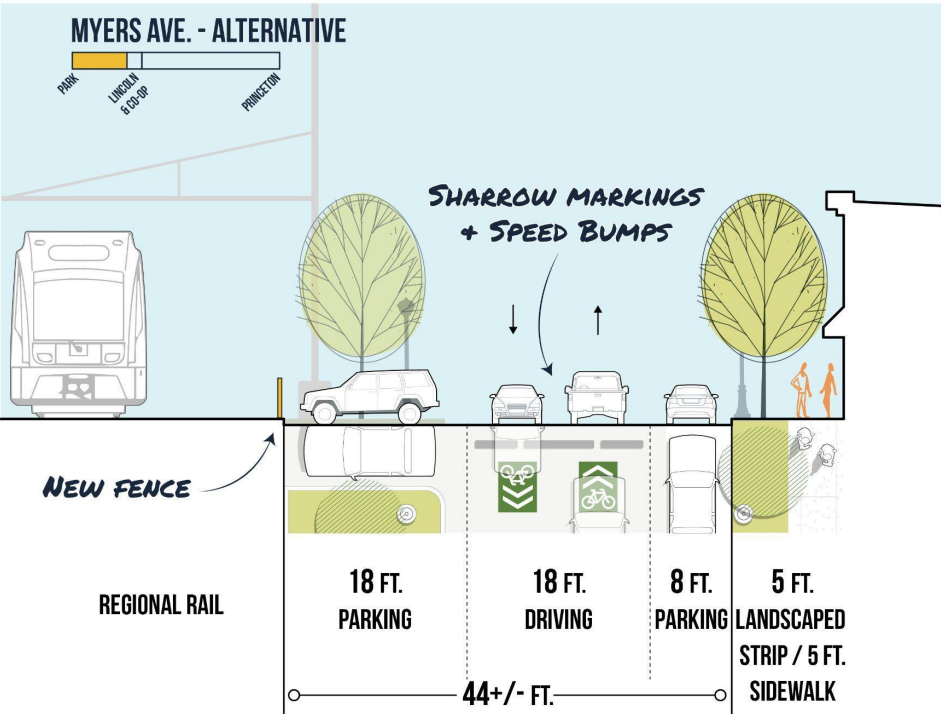

-32 parking spaces

Options Summary

Options	Pros	Cons
Option 1: Sidewalk on South Side, two-way	<ul style="list-style-type: none">● Maintains two-way traffic.	<ul style="list-style-type: none">● Not as safe for pedestrians.● Narrow passage on Myers near underpass.
Option 2: Sidewalk on North Side, two-way	<ul style="list-style-type: none">● Maintains two-way traffic.● Safe for pedestrians.	<ul style="list-style-type: none">● Need SEPTA easement*.● Narrow passage on Myers near underpass.
Option 3: Sidewalk on North Side, one way	<ul style="list-style-type: none">● Safe for pedestrians.● Offers parking flexibility.	<ul style="list-style-type: none">● One-way traffic.

* Could minimize planting area on South side if issue with SEPTA easement.

Next Steps

Meet with SEPTA to determine right-of-way and easements.

Meet with DVRPC and Pennoni to create grant calendar.

Schedule meeting with Interface and Co-op to address area behind Co-op.

Finalize the optimal design for grant applications.

Pennoni develop materials and estimates for grant applications.

Borough applies for grants.